

exlabesa
windows & doors
the collection

exlabesa

Aluminium window & doors & facades systems



exlabesa has a solid business background of more than 50 years and is currently one of the world leaders in the extrusion of aluminum profiles for the architecture and industry in general.

In the building systems division, **exlabesa** manufactures and develops aluminium windows & doors & façade systems that contribute to the well-being and comfort of people, the sustainability of our buildings and the improvement of our environment.

exlabesa also has capacity to complete the aluminium production cycle thanks to its **22 extrusion lines** (ranging from 13 MN to 65 MN), **11 thermal break assembly lines**, **30 machining centres**, **9 powder coating plants**, **5 anodizing plants**, **1 bending centre** and **1 recycling plant** spread over 8 production centres located in countries such as United Kingdom, Spain, Poland, Germany, Morocco or the United States.

exlabesa systems

- Casement windows & doors
- Sliding windows & doors
- Tilt & Turn windows
- Bi-folding doors
- Residential doors
- Shopfronts
- Curtain wall

exlabesa building systems Ltd.

Ogden Road - Wheatley Hills
DONCASTER DN2 4SG
Tel. +44 01302 762500 Fax + 44 01302 762557
www.exlabesa.co.uk

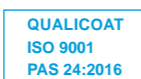

exlabesa building systems Ltd. prohibits total or partial reproduction of this brochure by any written means, as well as magnetic or electronic devices, without our express and written authorization.
exlabesa building systems Ltd. reserves the right to modify, improve or remove without prior notice any of the products shown in this catalogue.
exlabesa building systems Ltd. is not responsible for possible mistakes that may occur in this brochure and recommends verifying that the references appearing here are correct before making any order.
The material lists, modulations and discounts included in all models are illustrative and it is the customers responsibility to carry out the pertinent checks before proceeding with an order.

exlabesa building systems UK

Proudly made in Great Britain



exlabesa building systems UK is the UK subsidiary of the exlabesa group.

All **exlabesa** UK products are **manufactured at our 9-acre factory based in Doncaster – South Yorkshire** equipped with 2 state-of-the-art extrusion lines (3500 & 1600 tons), 1 vertical paint line (Qualicoat approved), 1 anodizing plant (Qualanod approved), 1 polyamide assembly line and a large stockage area.

Our windows, doors and façade systems are also technically **adapted and tested to meet British and industry standards**, ensuring our customers always receive quality aluminium products and best possible performance.

Most of them have also **PAS-24 accreditation**, so offer reassuring security as well as meeting the requirements of **Document Q of Building Regulations**.

At our Doncaster premises we have also a showroom where all the main windows systems can be seen, so call us on +44 01302 762 500 and make an appointment to visit us.

exlabesa building systems Ltd.

Ogden Road - Wheatley Hills
DONCASTER DN2 4SG
Tel. +44 01302 762500 Fax +44 01302 762557
www.exlabesa.co.uk

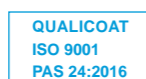

Who we are

Since 1966: **exlabesa**, your single source aluminium supplier



At **exlabesa** we know that completing the productive cycle of aluminium means providing value to our customers and that is why our business development has been focus, since our beginnings, to consolidate us as a reliable, differentiated and competitive supplier, capable of carrying out all the productive processes of the aluminium. From the conception, the design and development of the window, door or curtain wall system, to the extrusion, painting, packaging and delivery of the profiles totally finished.

- 1966 Valga, SPAIN
- 1992 Padron & Rois, SPAIN
- 2001 Doncaster, UNITED KINGDOM
- 2007 Tanger, MOROCCO
- 2009 Tutowice, POLAND
- 2011 Tifton, UNITED STATES
- 2016 Minden, GERMANY

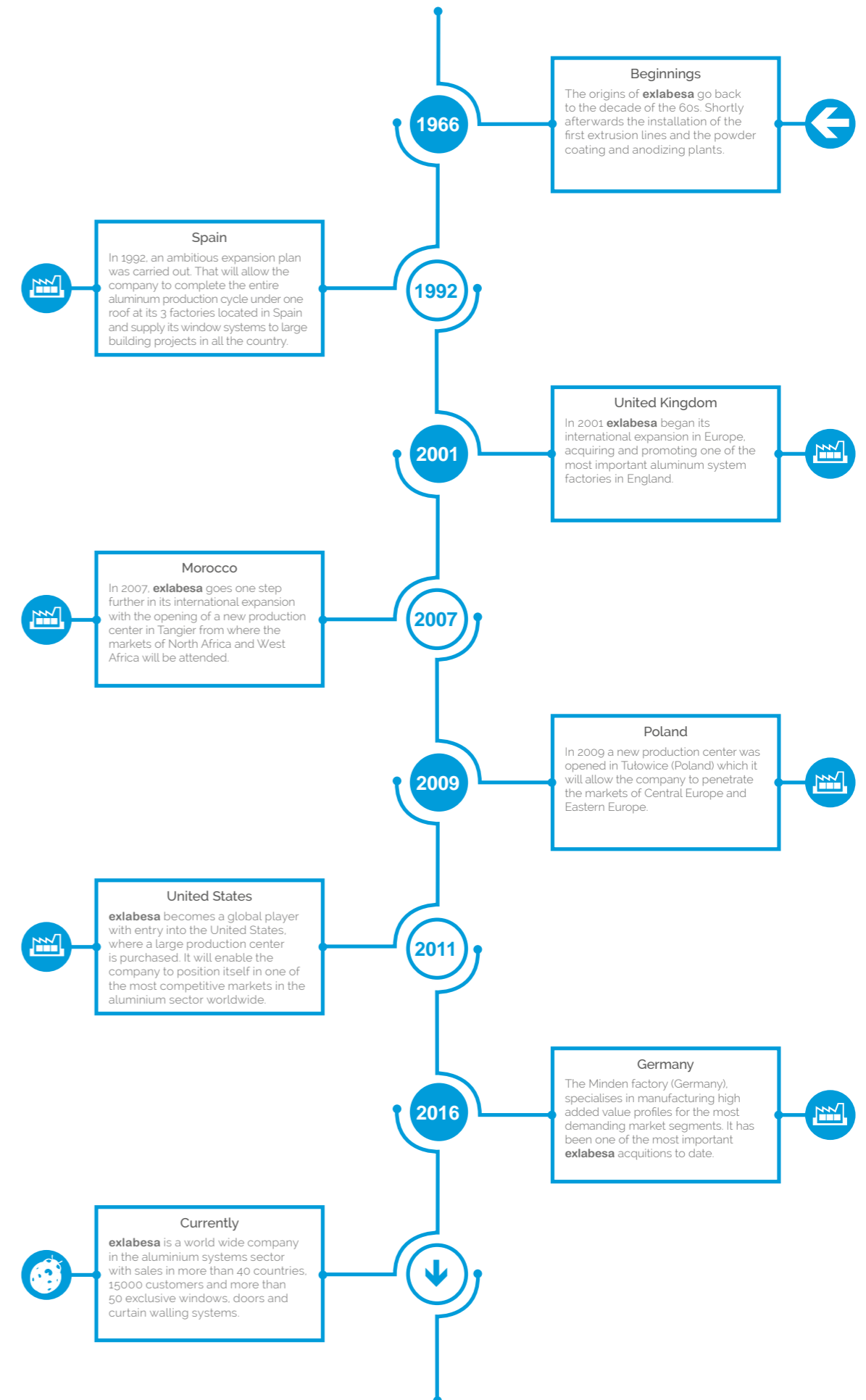

Identity exlabesa

Differentiated company culture



The wide trajectory of our company has served not only to consolidate a leading business project in the aluminium sector in Europe, but also to create a **differentiated company culture** that perfectly combines the expertise of a **professional, responsible and human committed team** with the **pride** of belonging to a company that puts the **satisfaction of its clients** and the **professional development** of its team before any other objective.

Currently, **exlabesa** is formed by more than 1800 people of different nationalities that are spread among the 16 work centres located in countries such as the United States, England, Germany, Spain, Poland or Morocco.

exlabesa global

The customer at the core of our strategy

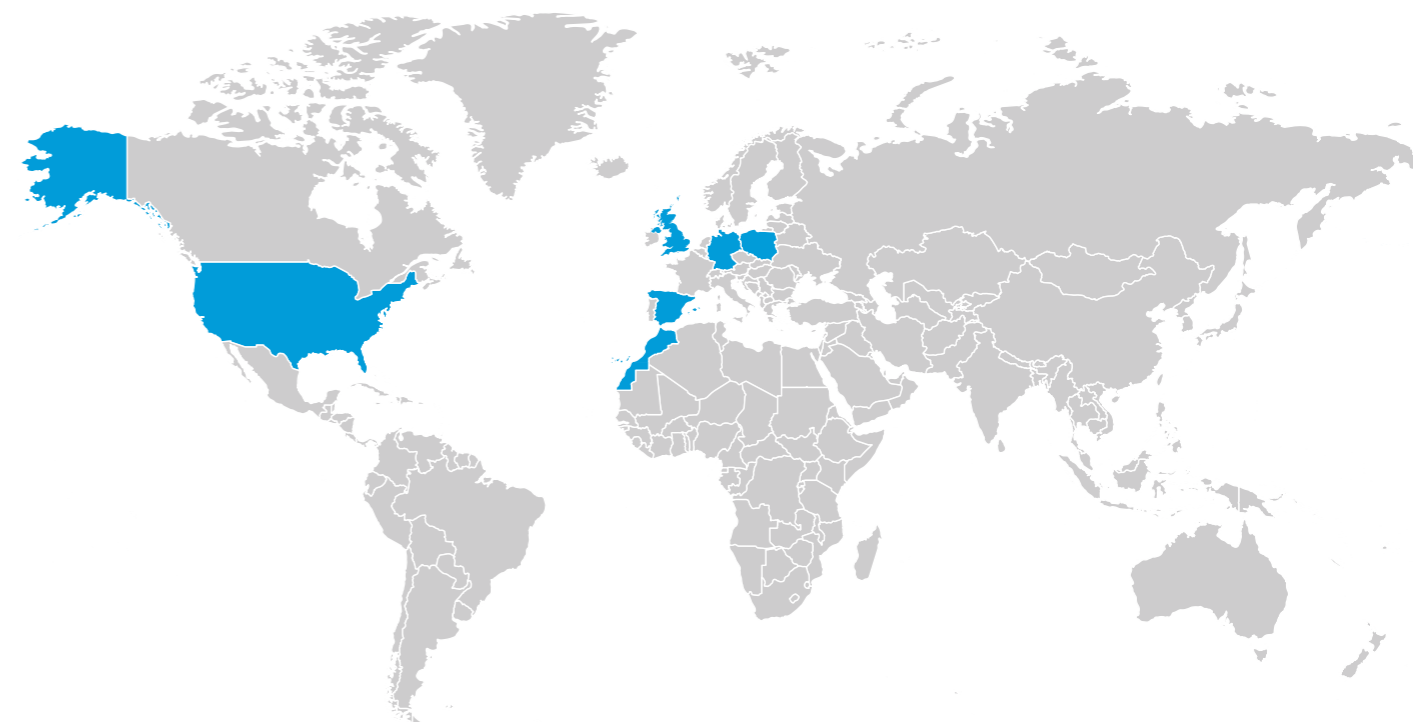

One of the main pillars on which the business model of **exlabesa** is based is the **constant investment in state-of-the-art machinery and technologies** that allow us to **create value** throughout the entire aluminium production chain and, in the end, **exceed our customer's the expectations**.

In addition, we understand that, in order to guarantee an impeccable service and to provide our customers with effective and immediate solutions we must provide a **proximity** and **customised** advice.

That is why we currently have **8 production centers** located in **3 continents** from where we supply our products to companies located in more than **40 countries** allowing us to implement a business philosophy that can be summarized as **"think global, act local"**.

8 PRODUCTION CENTRES

- Valga, SPAIN
- Padron, SPAIN
- Rois, SPAIN
- Doncaster, UNITED KINGDOM
- Minden, GERMANY
- Tułowice, POLAND
- Tanger, MOROCCO
- Tifton, UNITED STATES

Facts & figures

Reliability and competence

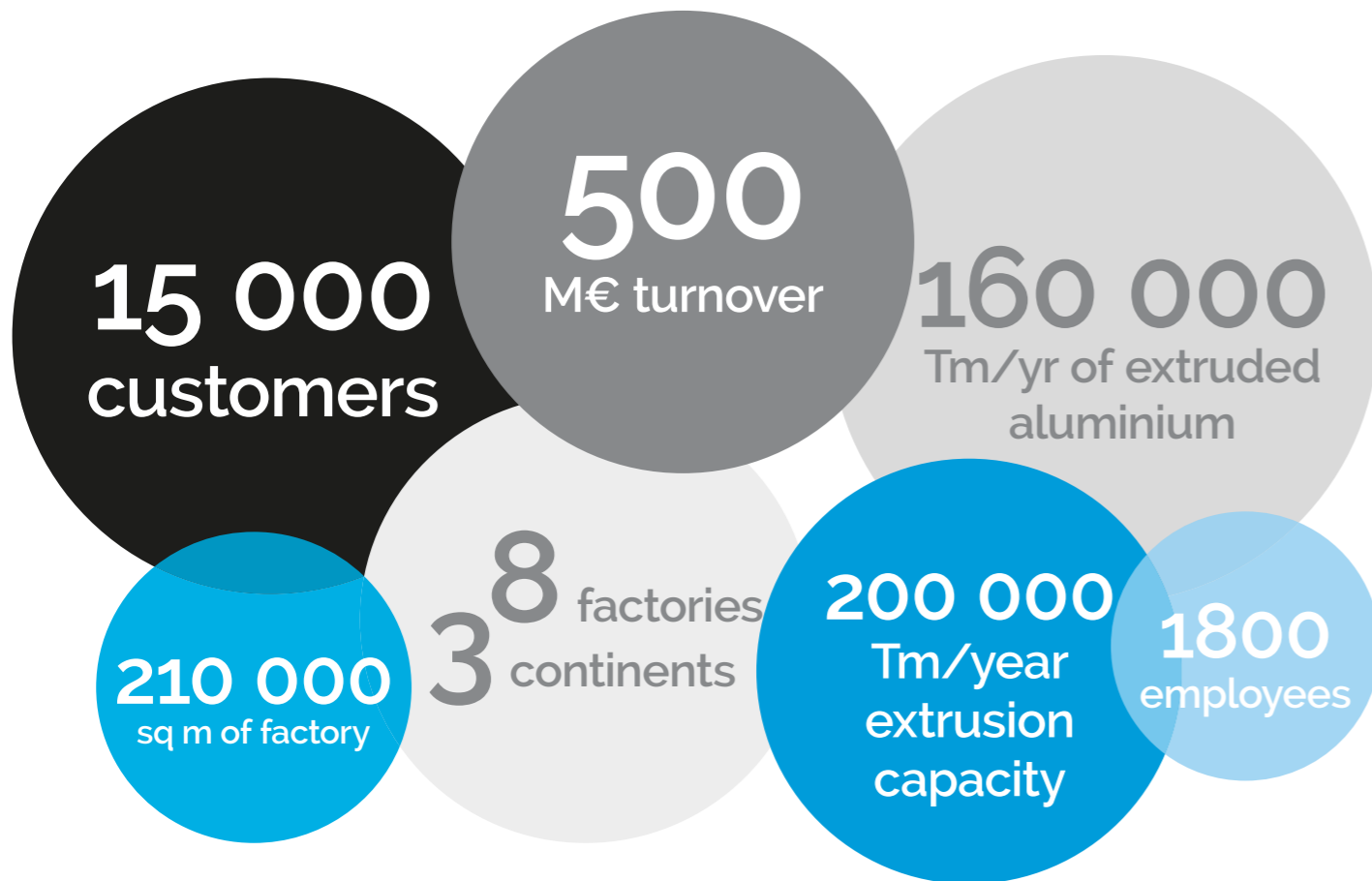

Thanks to the **commitment, professionalism and responsibility** of the people who form our team and the **trust** that our customers place in us every day, **exlabesa** is currently **one of the most reliable and most competitive** companies in the aluminum sector **worldwide** as the numbers show us:

- 500 million euros turnover
- 15 000 customers
- 1800 employees
- 160 000 Tm/yr of extruded aluminium
- 200 000 Tm/year extrusion capacity
- 210 000 sq m of factory
- 8 factories on 3 continents
- Sales in more than 40 countries

Quality and guarantees

Trust is proven, not asked for



At **exlabesa** we have managed to provide added value to all the processes that make up our activity, which has positioned us as quality leader in the industry.

We work constantly to optimised our aluminium windows, doors and curtain walling systems which is why our product quality lies not only in the rigorous quality controls that we carry out within our premises or in collaboration with prestigious certification companies (Air / Wind / Water Testing, PAS 24:2016, metallographic and resistance tests, chemical composition of our alloys) but also in the implementation of continuous actions that can improve our daily operations.

Our surface treatment such as powder coating painting or anodizing meet also the most demanding international standards which is why our plants hold **Qualicoat** and **Qualanod** labels that highlight its high quality.

At **exlabesa** we are certified by the **ISO 9001 Quality Management System** and the **ISO 18001 Occupational Health and Safety Management System**, to ensure that we have an effective organization that allows us to meet our goals, as well as guaranteeing that our team members are in an environment that facilitate the performance of their tasks.

exlabesa has created a value chain in which not only the final product is prioritised, but also gives importance to all production processes.

Why choose exlabesa

Benefits and advantages



Besides having a large and professional range of aluminium windows, doors and façade systems, **exlabesa** products offer clear benefits and advantages to our customers.

- Extruded in the UK
- Fabricator friendly systems
- Stock level reduction thanks to the compatibility of both sections and accessories across the ranges
- Superb balance of quality-service-price
- Industry leading lead times on both single and dual colours.
- Vast range of standard powder coat colours at the same price point
- Dedicated loan punch tooling for most of the preparations without any cost to the customer

index of systems

- 12 Specifications summary
- 15 Casement windows
 - 16 KC51
 - 18 KC75
 - 20 KS59
- 23 Tilt & Turn window
 - 24 KT51
- 27 Sliding doors
 - 28 KLS
 - 30 Xlaslide
- 33 Bi-folding door
 - 34 Xlafold
- 37 Residential door
 - 38 KD51
- 41 Curtain wall
 - 42 ECW-50
 - 44 KLW
- 47 Shopfront
 - 48 KTS
 - 50 KSF

Specifications summary

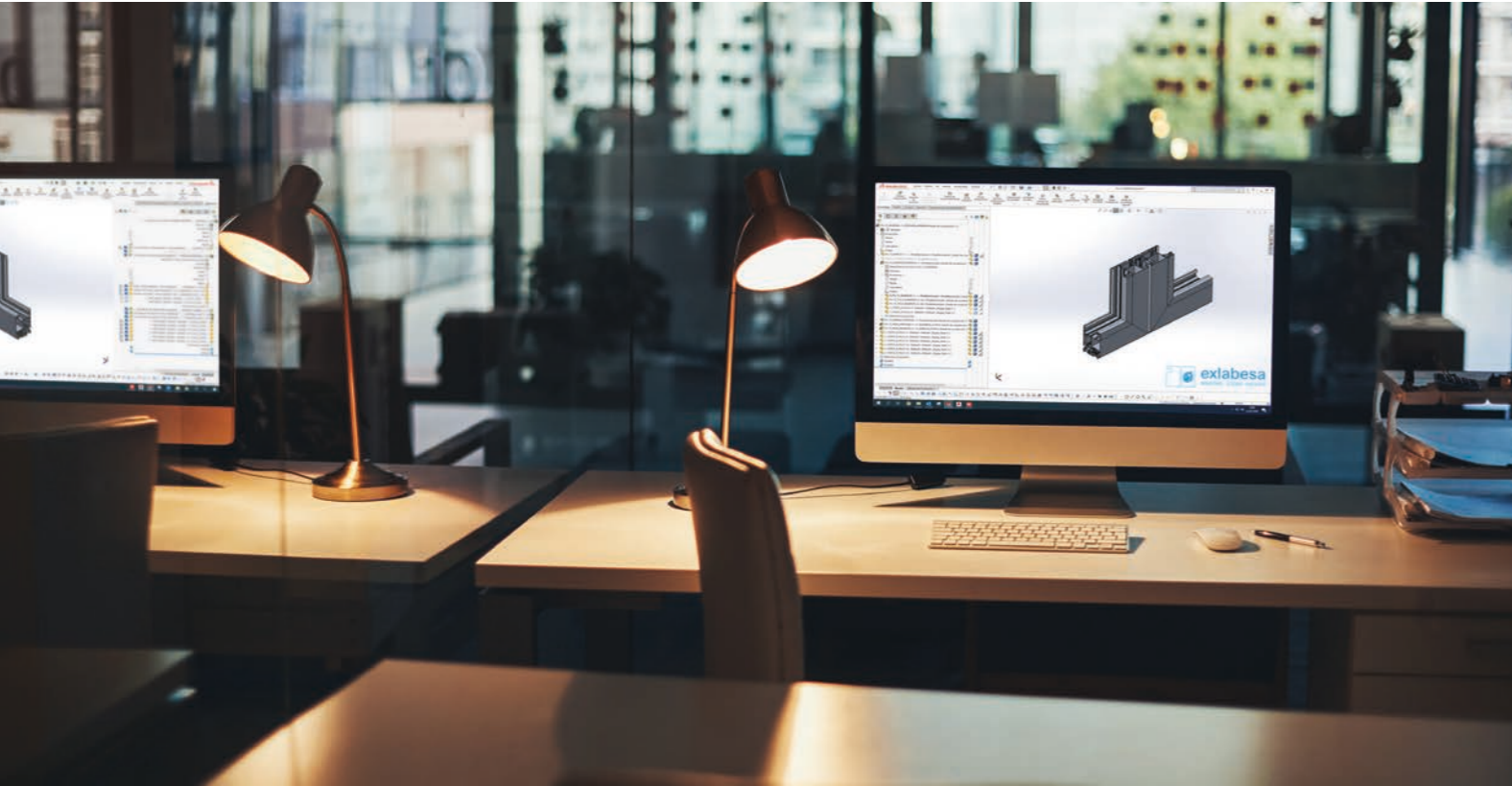

	Air permeability (Pa)	Watertightness (Pa)	Wind load (Pa)	U _w (W/m ² K)	U _f (W/m ² K)
CASEMENT					
KC51	600	1050	2000	1.5	2.8
KC75	600	600	2000	1.5	2.6
KS59	600	600	2000	1.6	2.8
SLIDING					
KLS	600	150	800	1.5	3.9
Xlaside	300	200	1600	1.5	3.2
TILT & TURN					
KT51	600	450	2000	1.5	2.5
BI-FOLDING					
Xlafold	600	450	1200	1.5	3.1
RESIDENTIAL DOOR					
KD51	—	—	—	2.0	3.0
SHOPFRONT					
KTS	—	—	—	1.9	2.9
KSF	—	—	—	—	—

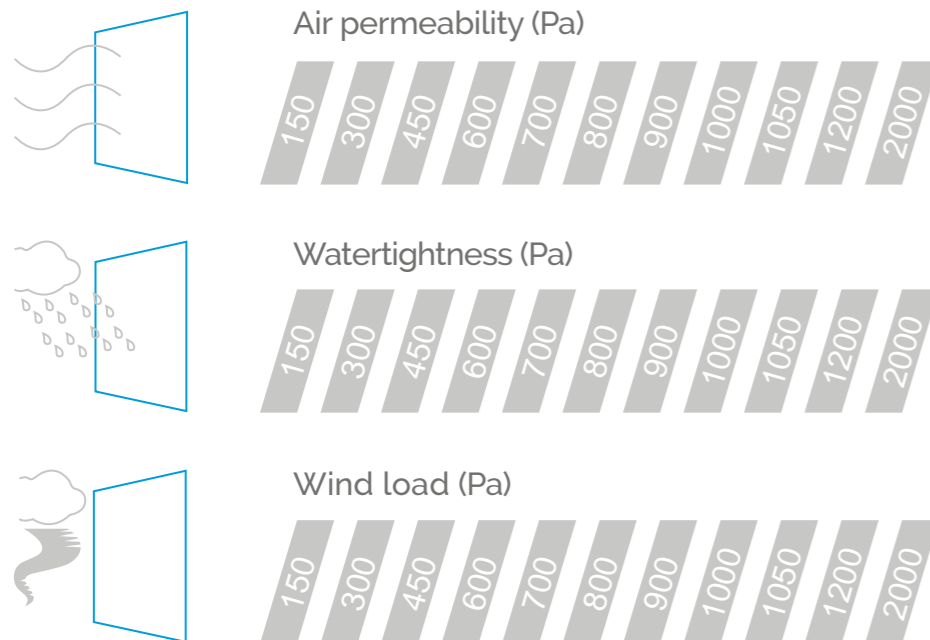

casement windows

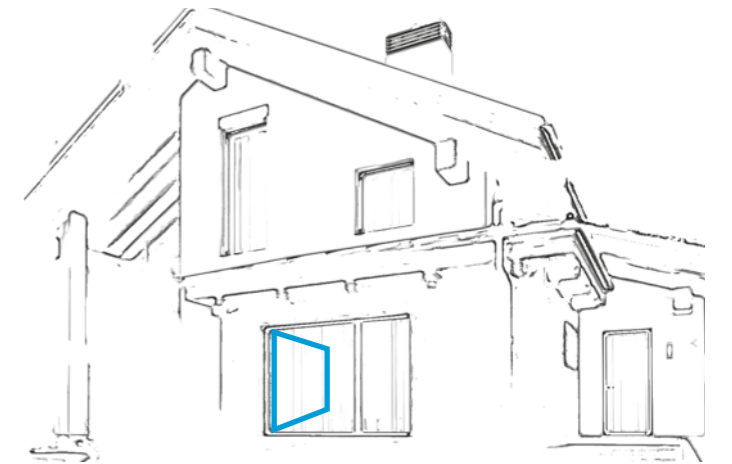

exlabesa building systems Ltd.

Ogden Road - Wheatley Hills
DONCASTER DN2 4SG
Tel. +44 01302 762500 Fax +44 01302 762557
www.exlabesa.co.uk

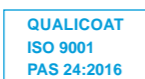

KC51

Casement window



Innovation and aesthetics united in a single system. **KC51 Casement window** mixes a modern and contemporary appearance with optimal technical features, especially its safety and energy saving benefits.

- Top and side hung applications
- 24 mm polyamides
- 28 mm glass, as standard
- Joined using mechanical corners
- 75 mm polyamide sub frame section, for easy to install modular windows
- Egress options available
- Cills, add ons, curtain wall insert and coupler sections available

Maximum size	1500x1500 mm top hung 900x1500 mm side hung
Maximum weight	50 kg
Maximum glazing	32.8 mm
Polyamide	24 mm
U _w value*	1.5 W/m²K
U _f value (HOi)	2.8 W/m²K

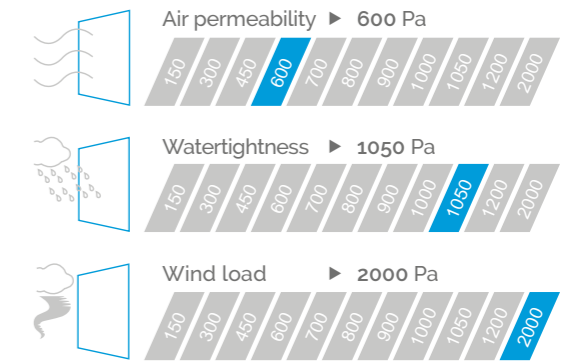

Air/Water/Wind tests according to standard BS6375-1
*1500x1500 mm & 1.1 mm glass

✓ PAS24 Security ✓ BS6375-2 ✓ BS6375-3

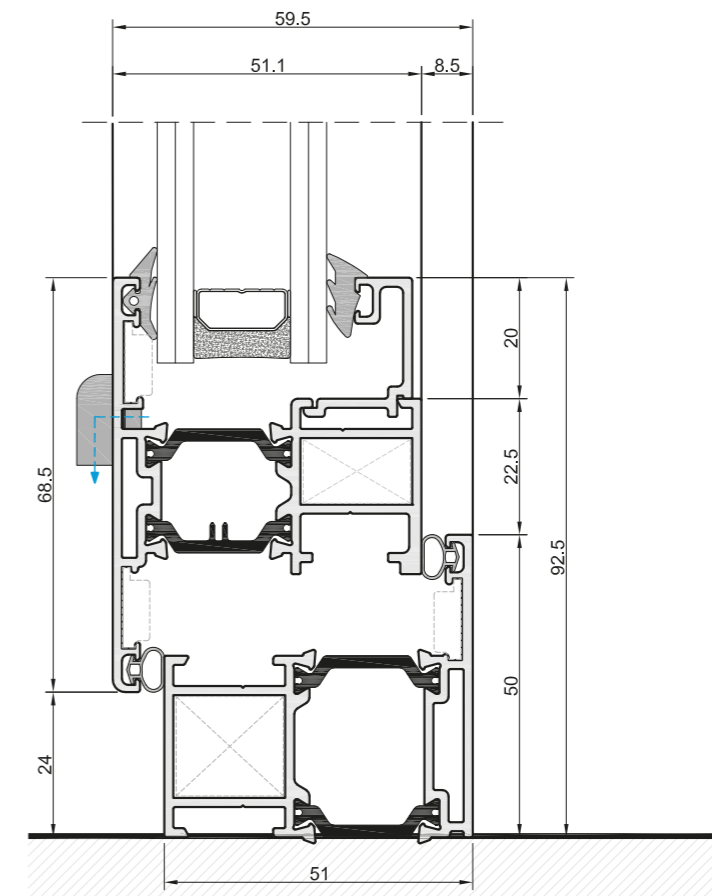

TYPICAL CONFIGURATIONS

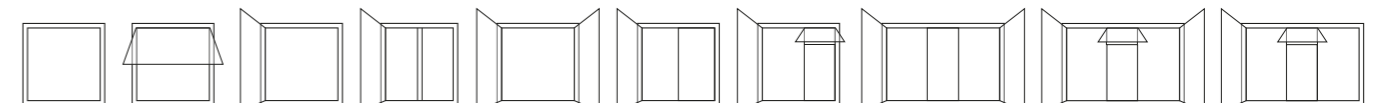

KC75

Casement window



Maximum size	1500x1500 mm top hung 900x1500 mm side hung
Maximum weight	50 kg
Maximum glazing	56 mm
Polyamide	32 mm
U _w value*	1.5 W/m ² K
U _f value (HOi)	2.6 W/m ² K

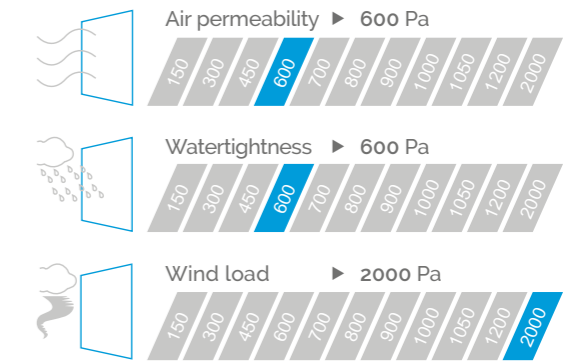

Air/Water/Wind tests according to standard BS6375-1
*1500x1500 mm & 1.1 mm glass

✓ PAS24 Security

✓ BS6375-2

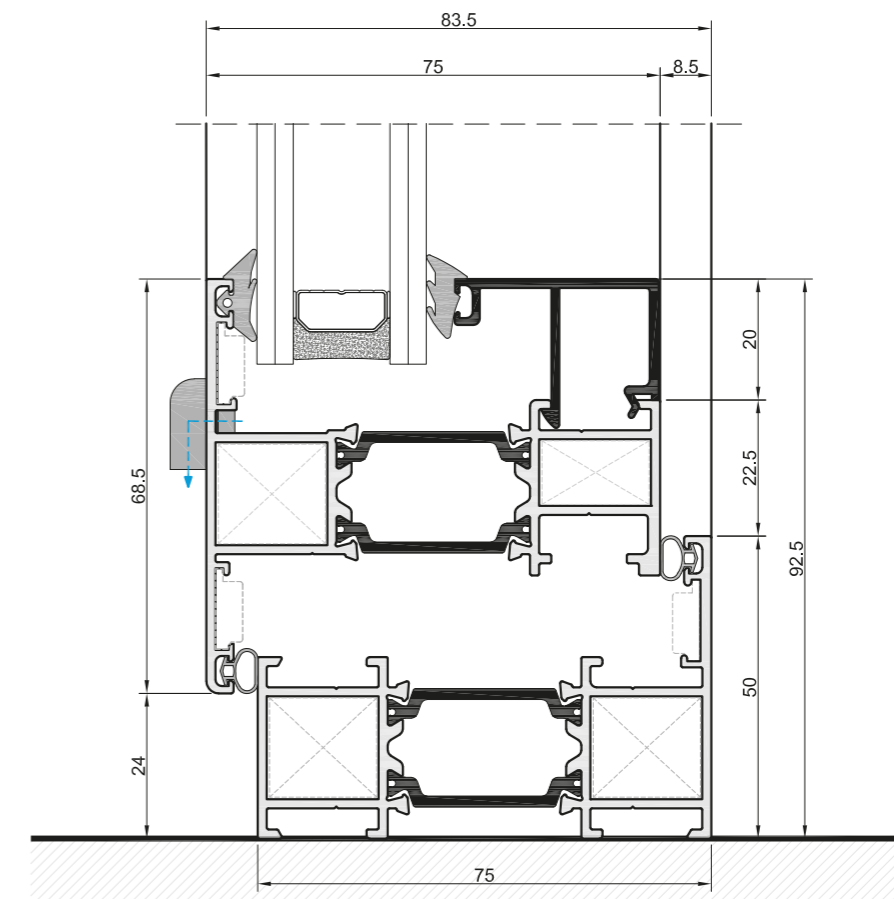

TYPICAL CONFIGURATIONS

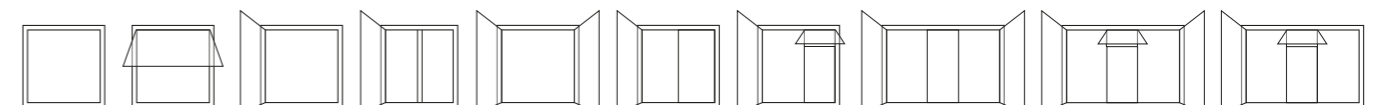

Aluminium windows make a stunning statement in any home. KC75 aluminium windows have slim frames that maximise the amount of natural light, making them perfect for both traditional and modern homes.

With a choice of design options, the windows come with a multitude of practical features for today's modern day living while exceeding the energy performance requirements of current Building Regulations.

- Top and side hung applications
- Joined using mechanical corners
- 75 mm polyamide sub frame section, for easy to install modular windows
- Egress option available
- Slimline internal glazing option
- Cills, add ons, curtain wall insert & coupler sections available

KS59

Casement window



Maximum size	1200x1500 mm top hung 600x1500 mm side hung
Maximum weight	50 kg
Maximum glazing	28 mm
Polyamide	24/32 mm
U _w value*	1.6 W/m²K
U _f value (HOi)	2.8 W/m²K

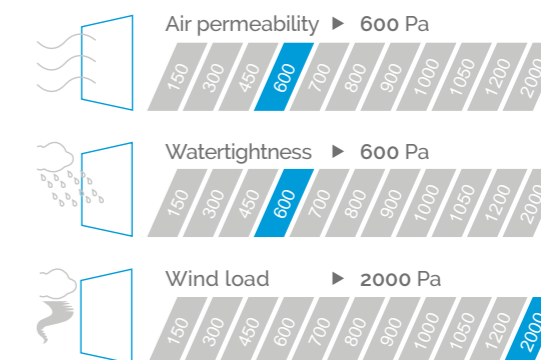

Air/Water/Wind tests according to standard BS6375-1
*1200x1500 mm & 1.1 mm glass

✓ PAS24 Security

✓ BS6375-2



A modern design that maximizes the glazed area is a must in any windows system. **KS59 Steel lookalike casement window** is designed to mimic steel windows. This open out window system unities performance and practicality to give a contemporary look where slim sightlines and profiled sections stand out, making it an ideal choice for both refurbishments and new builds.

- Top and side hung applications
- 32 mm polyamide
- 28 mm glass, as standard
- Joined using mechanical corners
- Egress options available
- Cills, add ons and coupler sections available

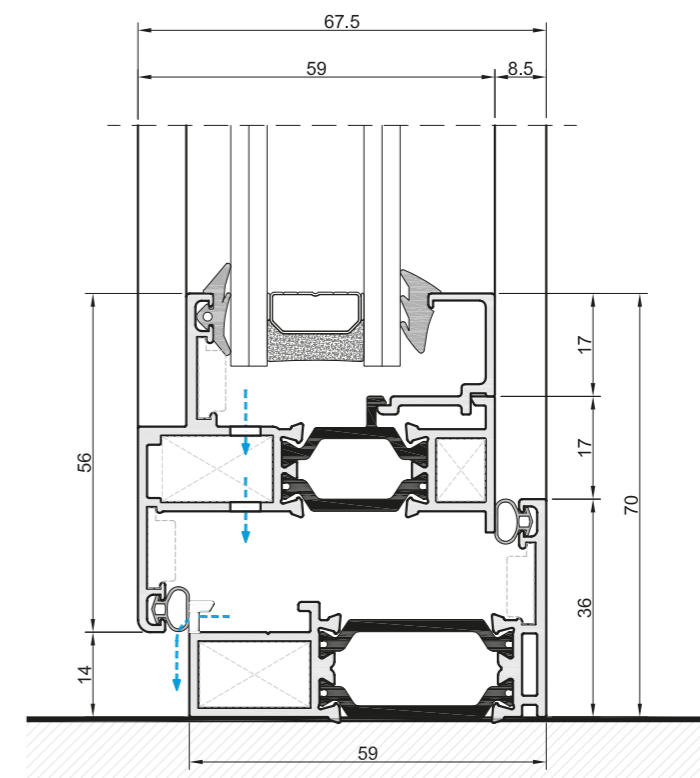

TYPICAL CONFIGURATIONS

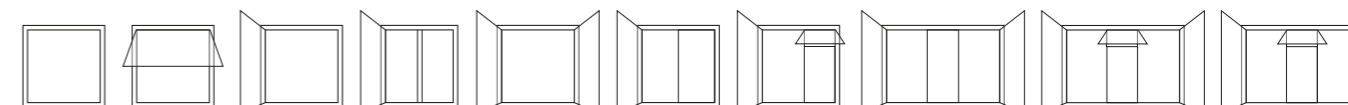

tilt & turn window

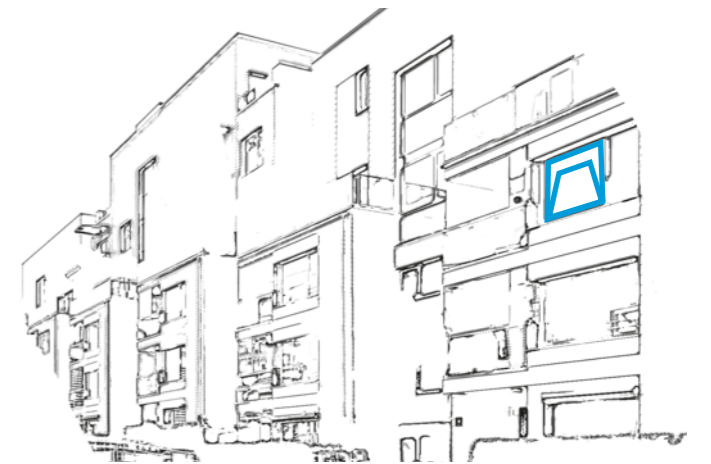

exlabesa building systems Ltd.

Ogden Road - Wheatley Hills
DONCASTER DN2 4SG
Tel. +44 01302 762500 Fax +44 01302 762557
www.exlabesa.co.uk

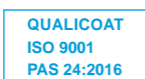

KT51

Tilt & Turn window



A system capable of adapting to the aesthetic and functional needs of each construction is essential in architecture. **KT51 Tilt & Turn** offers a huge range of adaptable options for any room thanks to the combination of its opening possibilities. Furthermore, its technical features are excellent, making this system one of the most complete in our range.

- Top and side hung applications, as well as Tilt & Turn
- 32 mm polyamide
- 28 mm glass, as standard
- Joined using mechanical corners
- Egress options available
- Cills, add ons, curtain wall insert and coupler sections available

Maximum leaf size	1500x2100 mm
Maximum weight	90 kg
Maximum glazing	32,8 mm
Polyamide	24/32 mm
U _w value*	1,5 W/m ² K
U _f value (HOi)	2,5 W/m ² K

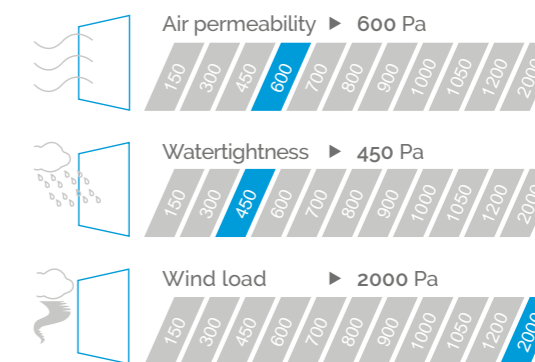

Air/Water/Wind tests according to standard BS6375-1
*1500x2100 mm & 1.0 mm glass

✓ BS7950 Security

✓ BS6375-2

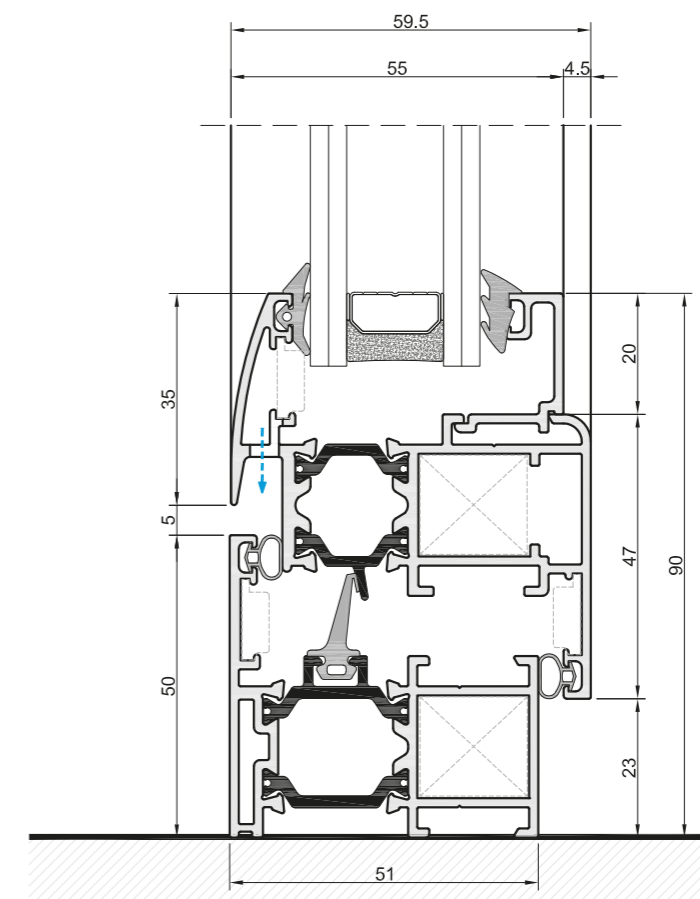

TYPICAL CONFIGURATIONS

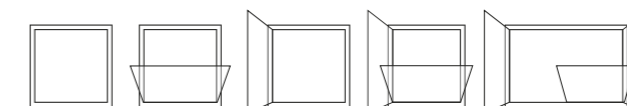

sliding doors

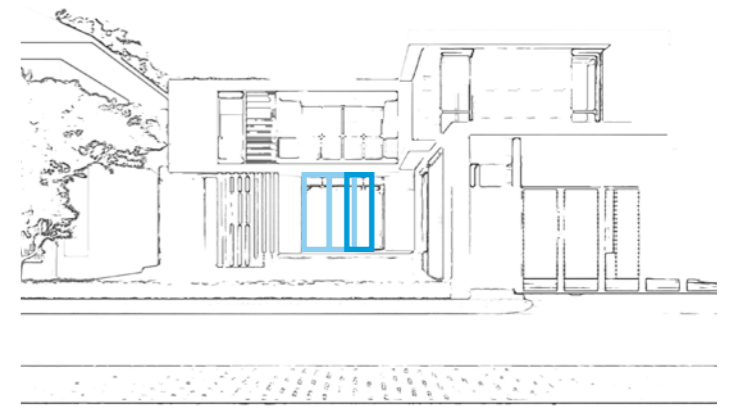

exlabesa building systems Ltd.

Ogden Road - Wheatley Hills
DONCASTER DN2 4SG
Tel. +44 01302 762500 Fax +44 01302 762557
www.exlabesa.co.uk

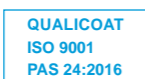

KLS

Lift & Slide patio door



Maximum leaf size	3300x3200 mm
Maximum weight	400 kg lift & slide 220 kg slide only
Maximum glazing	39.5 mm
Polyamide	24 mm
U _w value*	1.5 W/m²K
U _f value	3.9 W/m²K

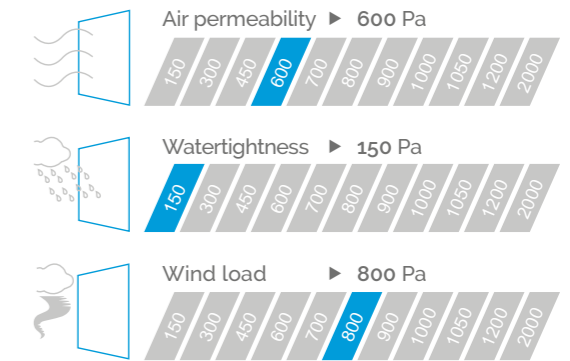

Air/Water/Wind tests according to standard Weather (EU test)
*5000x3200 mm 2 pane & 1,0 mm glass



KLS aluminium patio door offers a full width clear opening to your terrace and garden. With the trend for large expanses of glass that give unrestricted views to the outside, the patio door delivers this better than any other type of door on the market.

Viewed from the inside or outside, the KLS aluminium patio door will transform the look of your room as well as your home.

- Mechanical corner joint for ease of fabrication
- Variation of glass thickness available
- Doors up to 400 kg available
- Outstandingly smooth & quiet sash movement
- Internally beaded for security
- Hardware designed to ensure ease of use

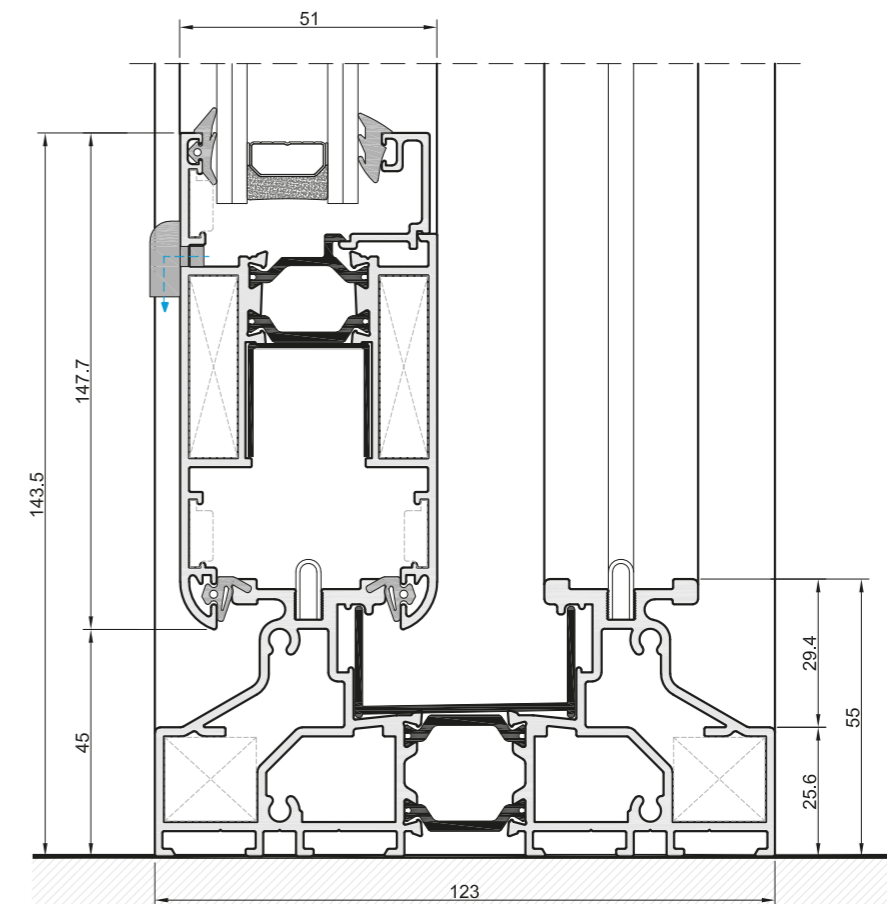

TYPICAL CONFIGURATIONS

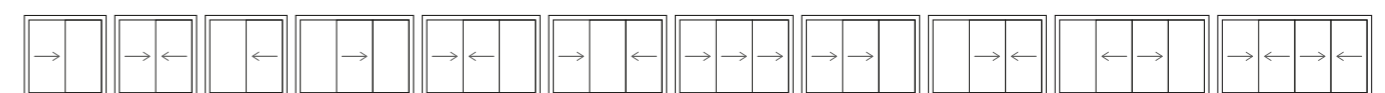

Xlaslide

Sliding patio door



Maximum size	2000x2430 mm
Maximum weight	200 kg
Maximum glazing	34 mm
Polyamide	24 mm
U _w value*	1,5 W/m ² K
U _f value	3,2 W/m ² K

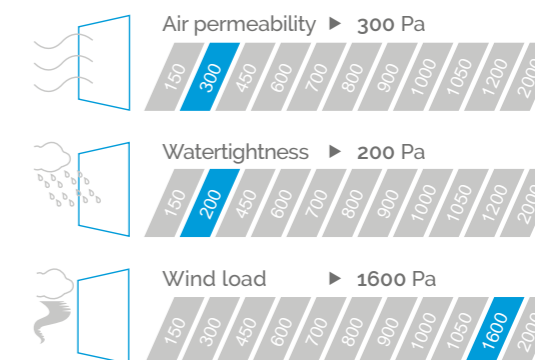

Air/Water/Wind tests according to standard BS6375-1
*3500x2100 mm 2 pane & 1.0 mm glass

PAS24 Security (52 mm only)



Connecting spaces with the exterior giving significance to glass is a trend in architecture. **Xlaslide Sliding patio door**, with its modern design focused on its slim sightlines, provides an extraordinary connection with the outside maximizing the sunlight entry into the room.

- Mechanical corner joint for ease of fabrication
- Slim 32 mm interlock available
- Slim sightlines
- Twin & Triple track options
- Internally beaded for security
- Doors up to 200 kg available

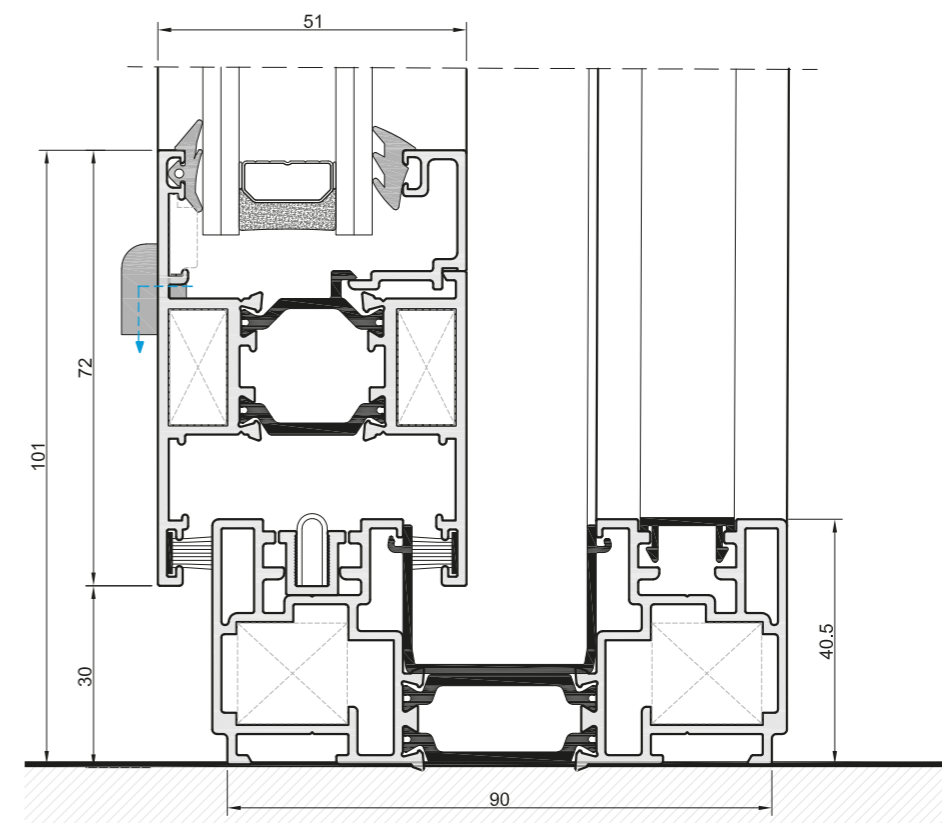

TYPICAL CONFIGURATIONS

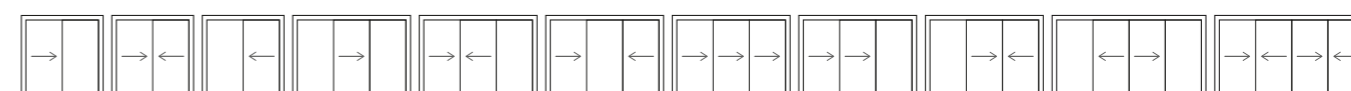

bi-folding door

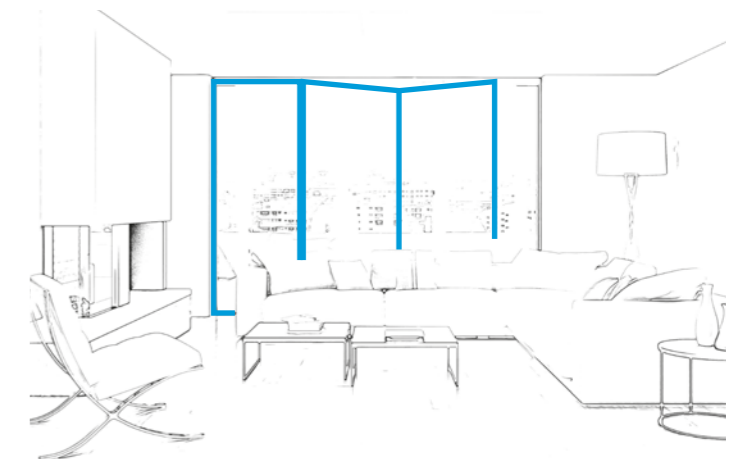

exlabesa building systems Ltd.

Ogden Road - Wheatley Hills
DONCASTER DN2 4SG
Tel. +44 01302 762500 Fax +44 01302 762557
www.exlabesa.co.uk

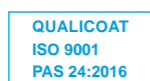

Xlafold

Bi-folding door



Nothing beats the feel-good factor of open living space. A seamless transition to outdoor living. Xlafold aluminium bi-folding doors offer superb slimline aesthetics with a strong, robust performance. This system maximises the glazed area thanks to their sleek, slimline aluminium profiles which deliver maximum light appeal.

- Range of configurations available
- Half rollers available for even panel number configurations
- Choice of glazing thickness' available
- Square or curved sash options
- Square or bevelled beads
- Internally beaded for security
- Open in and open out doors available
- "Master" doors with 3 point locking available

Maximum leaf size	1000x2400 mm
Maximum weight	100 kg
Maximum glazing	40 mm
Polyamide	20/32 mm
U _w value*	1,5 W/m ² K
U _f value	3,1 W/m ² K

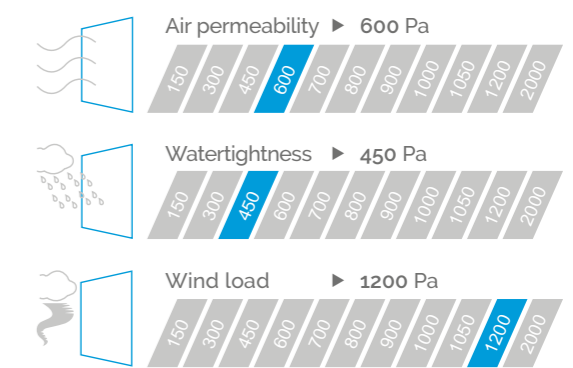

Air/Water/Wind tests according to standard BS6375-1
*3000x2100 mm & 1.0 mm glass

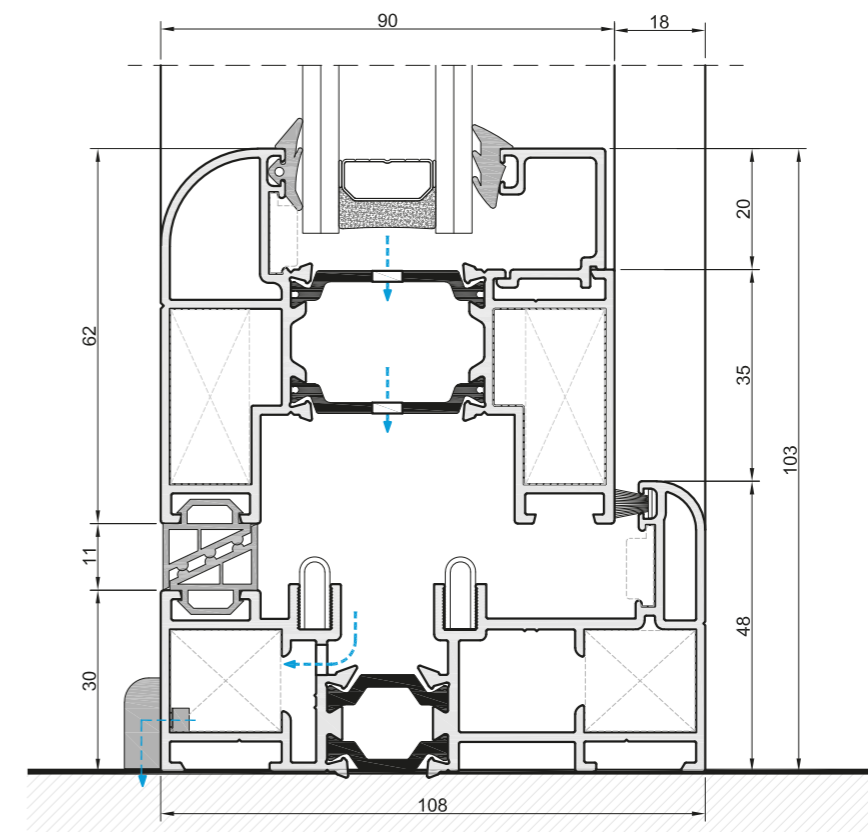

TYPICAL CONFIGURATIONS

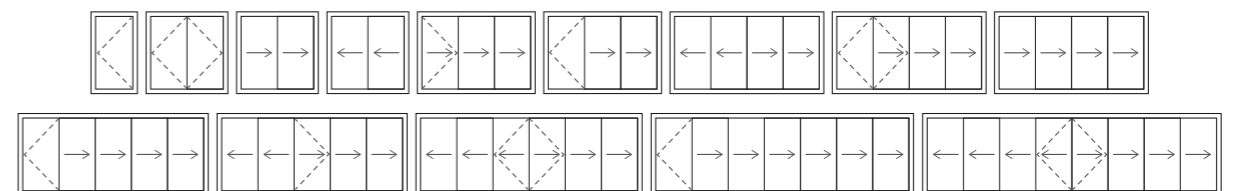

residential door

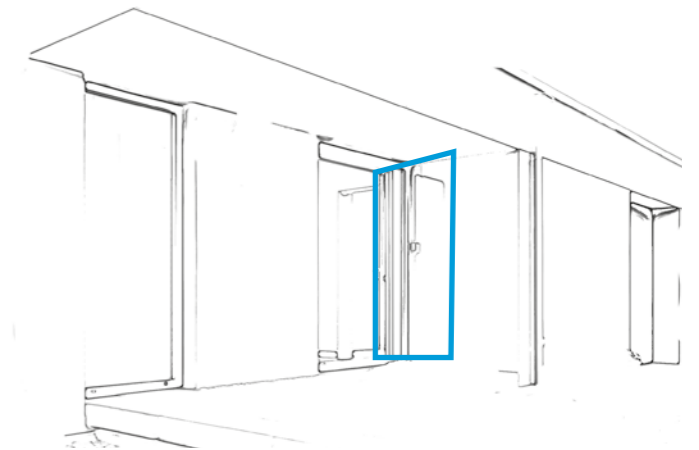

exlabesa building systems Ltd.

Ogden Road - Wheatley Hills
DONCASTER DN2 4SG
Tel. +44 01302 762500 Fax +44 01302 762557
www.exlabesa.co.uk

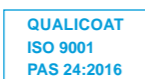

KD51

Residential door



Make an entrance to your home with an **KD51 aluminium entrance door**. Our aluminium rebated thermal doors create a beautiful entrance to match the style of your home perfectly.

Aluminium doors offer strength, durability and are highly resistant to corrosion for years of trouble-free use and operation. The natural strength of aluminium gives you beautiful sleek lines, less frame and more glass area.

- Inward & outward open application available
- 28 mm glass as standard as well as a wide variety of other options
- Joined using mechanical corners
- 75 mm polyamide sub frame section for easy to install modular doors
- Doors easily integrated with EBS window systems
- Cills, add ons, curtain wall insert & coupler sections available
- Multipoint locking available for secure doors

Maximum sash size	1100x2400 mm
Maximum weight	50 kg
Maximum glazing	32,8 mm
Polyamide	19 mm
U _w value*	2,0 W/m ² K
U _f value (HOi)	3,0 W/m ² K

*900x2100 mm & 11 mm glass

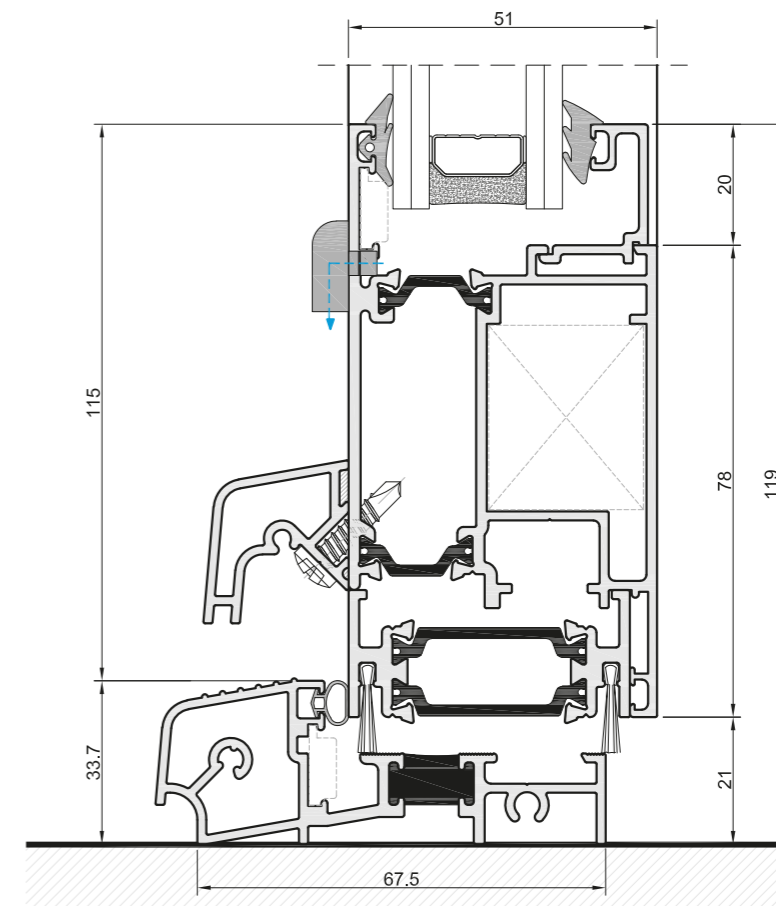

TYPICAL CONFIGURATIONS

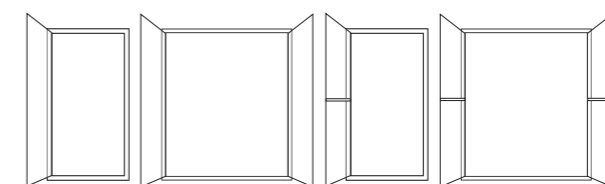

curtain wall



exlabesa building systems Ltd.

Ogden Road - Wheatley Hills
DONCASTER DN2 4SG
Tel. +44 01302 762500 Fax +44 01302 762557
www.exlabesa.co.uk

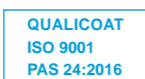

ECW-50

Curtain wall



Curtain wall allows a multitude of possibilities to achieve the uniqueness that all construction requires. **ECW-50 Curtain wall** allows the design of structures of great creativity and visual lightness with only 50 mm of front seen in the supporting structure.

- 50 mm stick curtain walling system
- Mullion sizes to 250 mm
- Transom sizes to 195 mm
- Polyamide thermal break for improved thermal efficiency
- Glazing to 46 mm
- Window & door insert available
- Internal reinforcing bars available for bigger spans
- A range of external caps available

Maximum weight	350 kg
Maximum glazing	46 mm
CWCT	Test cert available upon request

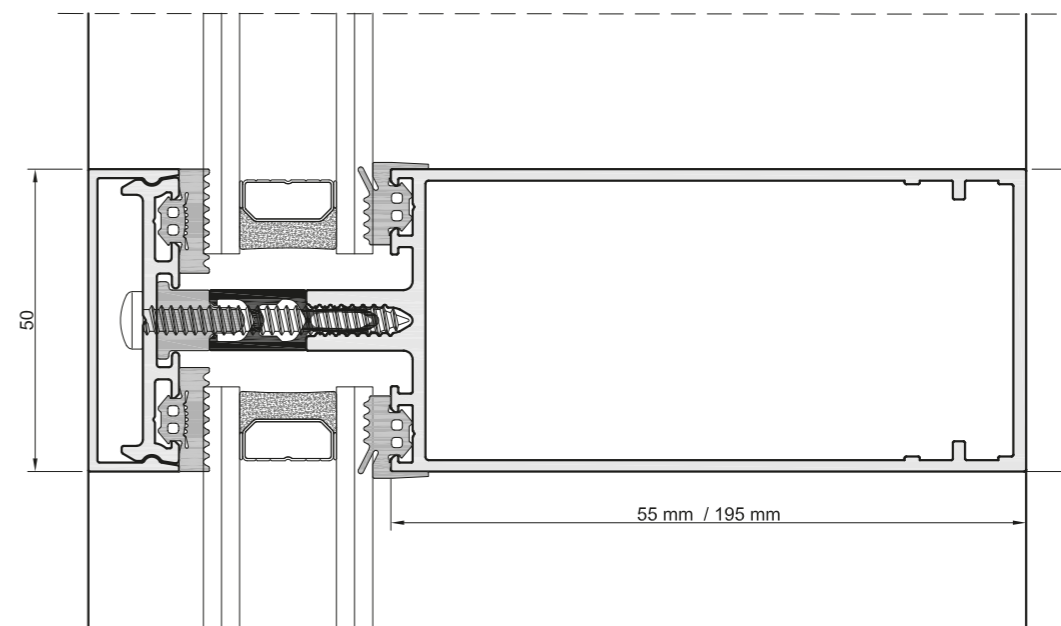

TYPICAL CONFIGURATIONS

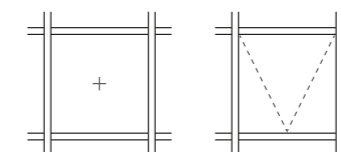

KLW

Curtain wall



Maximum weight	Consult exlabesa technical department
Maximum glazing	34 mm



A visually slim system that maximises the glazed area enhances the appeal of a façade. **KLW Curtain wall** system has only 50 mm wide making it ideal for a huge range of projects where glass has the main point.

- 50 mm channel & plate curtain walling system
- Transom/Mullion sizes from 50 mm to 125 mm
- Polyamide thermal break for improved thermal efficiency
- 28 mm glazing as standard
- Window & door insert available
- Faceted sections available for angled screens
- Internal reinforcing bars available for bigger spans
- A range of external caps available

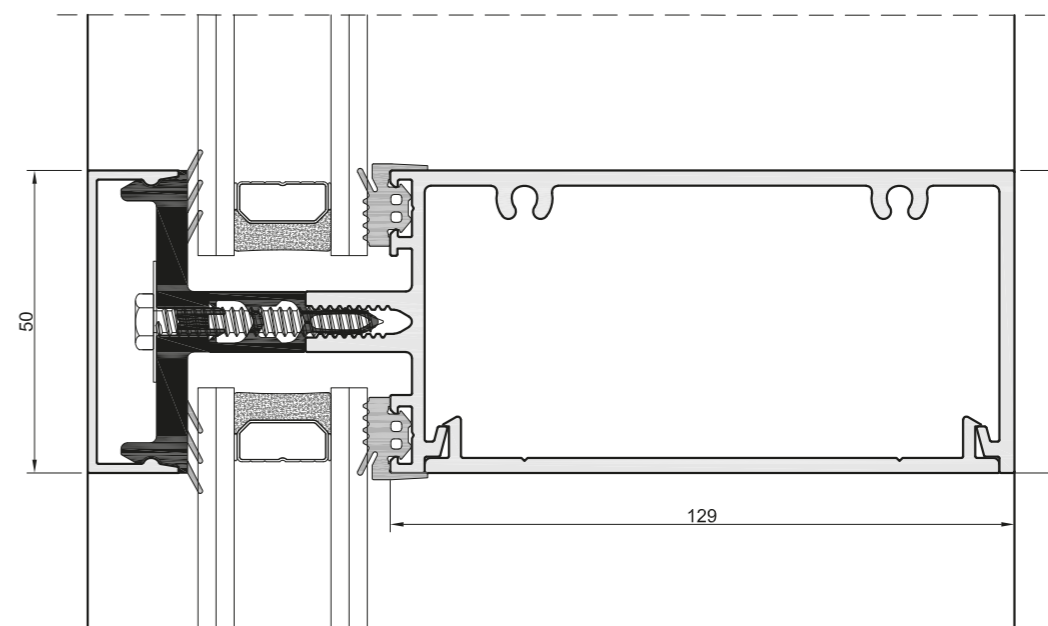

TYPICAL CONFIGURATIONS

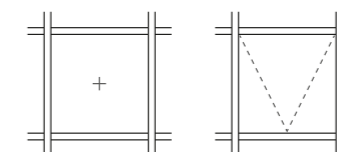

shopfront

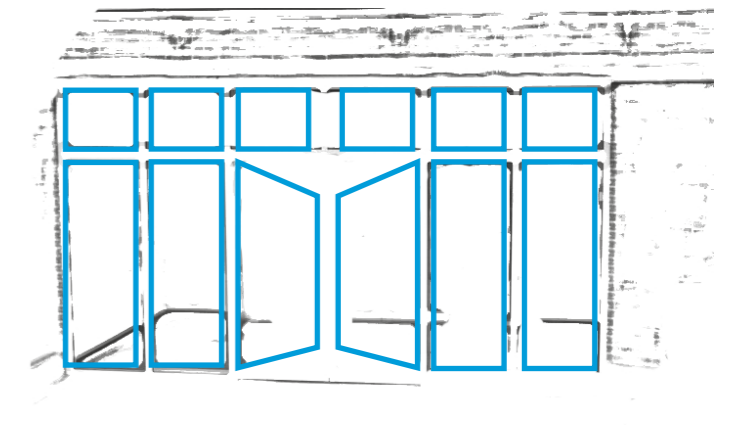

exlabesa building systems Ltd.

Ogden Road - Wheatley Hills
DONCASTER DN2 4SG
Tel. +44 01302 762500 Fax +44 01302 762557
www.exlabesa.co.uk

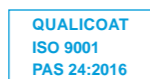

KTS

Thermal shopfront



Security is essential when we talk about a front door. **KTS Thermal shopfront** is a robust system that maximizes security and ensures high thermal isolation thanks to thermal breakage. This mix makes this system an ideal choice for any kind of shopfront.

- Range of shop front and door sections available
- Double glazed unit's standard throughout for improved thermal efficiency
- One section door leaf makes for a cost-effective system with little waste
- Mechanical corner joints on doors to make assembly simple
- Shop front and doors available in dual colour

Maximum leaf size	1150x2400 mm
Maximum weight	65 kg
Maximum glazing	28,8 mm framing 32,8 mm door
Polyamide	24/32 mm
U _w value*	1,9 W/m²K
U _f value	2,9 W/m²K

*1150x2100 mm & 1.0 mm glass

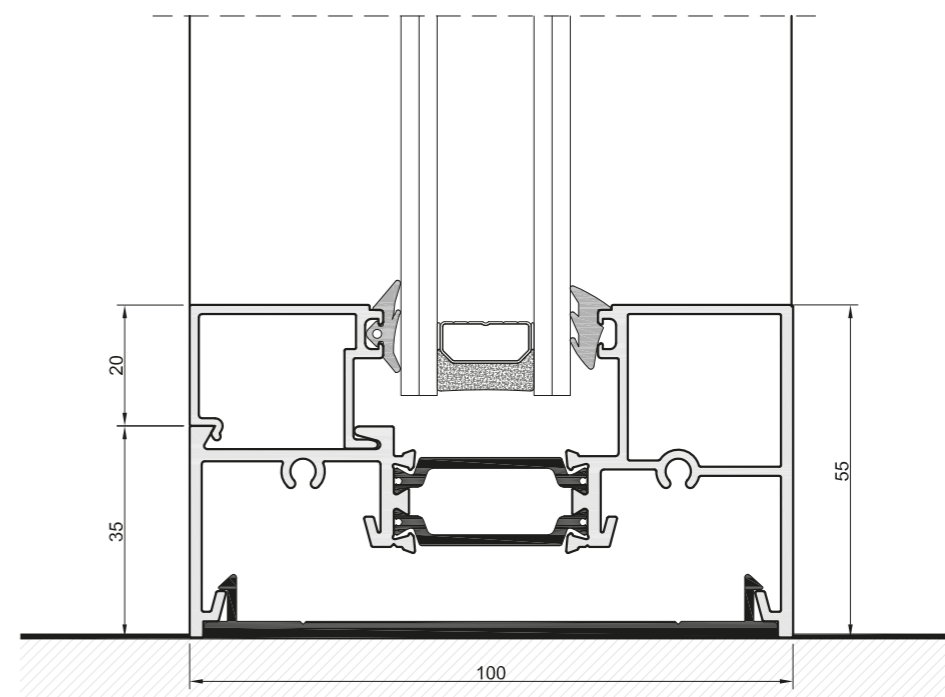

TYPICAL CONFIGURATIONS

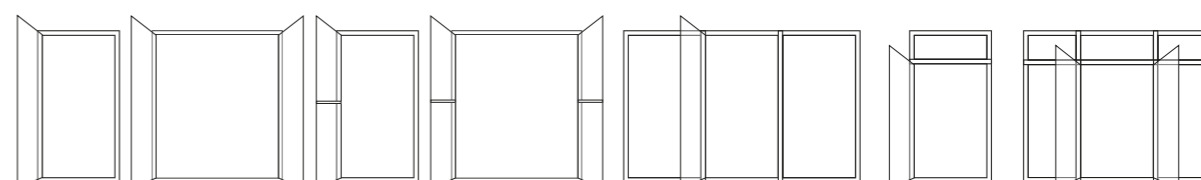

KSF

Shopfront



Maximum leaf size	1150x2400 mm
Maximum weight	65 kg
Maximum glazing	28.8 mm framing 32.8 mm door



A robust system designed thinking of its installation on shopfronts. KSF combines durability and a modern design that maximizes the glazed area with an excellent value for money. This door is not only an excellent option for exterior, it is also good choice to interior spaces.

- Range of shop front & door sections available
- Double & single door profiles available
- Choice of top rails, bottom rails and a mid-rails available
- Screw port fixing for shop front sections
- Multiple glass thickness' available from 6 to 28.8 mm double glazing
- Internally beaded for increased security
- Sections available for use with auto gearing as well as manual pivot

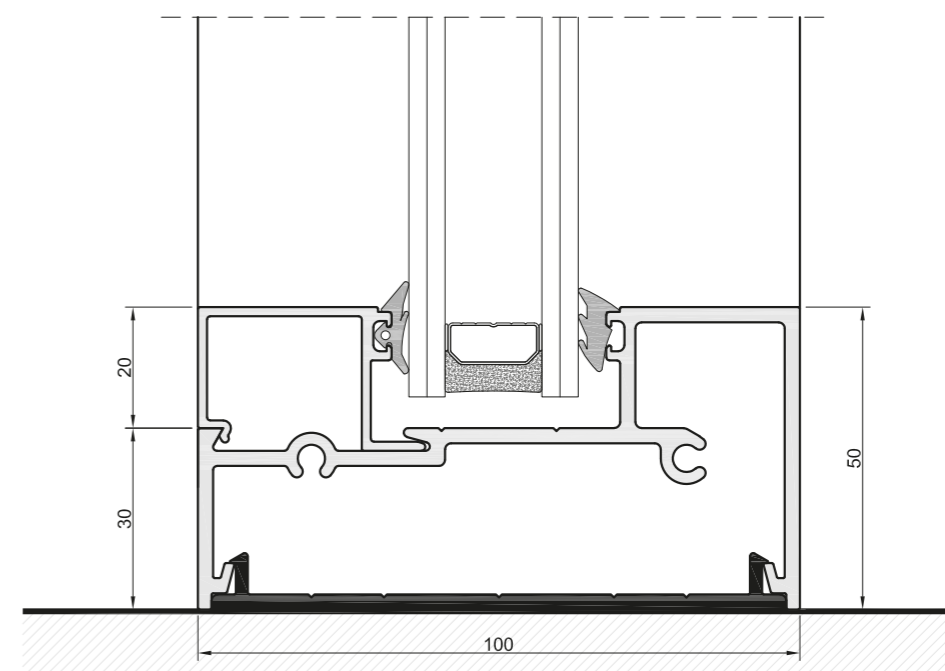

TYPICAL CONFIGURATIONS

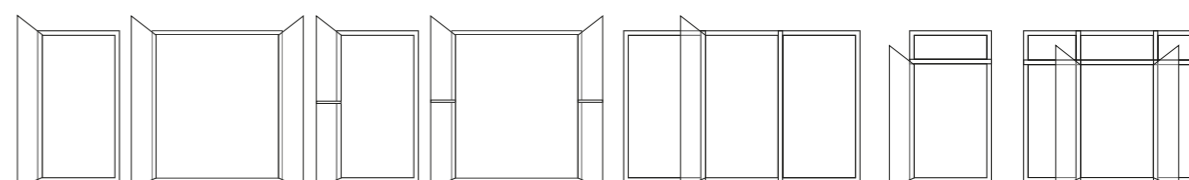

exlabesa Support Hub

Expertise in aluminium windows, doors and facades



At **exlabesa** we are aware of the uniqueness of each building project and that is why we have a technical team specialise in **aluminium systems** ready to team up with you to help you to achieve the best possible result.

From helping you to choose the **exlabesa** windows or doors system that best fits your requirements to train you to fabricate and assembly our products in the best and easiest way, the **exlabesa support hub** is always available to provide you a remarkable service.

We also offer you an extensive and a professional literature covering:

- Technical specifications
- Fabrication manuals
- CAD details

Within our customized services we also cover technical assistance for:

- U value calculation
- Glazing recommendation
- Intertia calculation
- Quotation and material list
- Windows & doors software training

To get more info about support hub please visit our website at www.exlabesa.co.uk or contact us on +44 01302 762 500.

exlabesa clean planet

Aluminium, an eco-efficient material



exlabesa Clean Planet is an initiative based on the principles of the **circular economy** that aims to improve the environment, develop a more sustainable production system and reduce the impact of our activity on the environment.

Thanks to our investments in several recycling plants, allows us to manufacture **eco-efficient aluminium billets**. This has allowed us to reduce in a very important way our environmental footprint.

Our recycled aluminium generates a minimal environmental impact as its **CO₂ footprint** is **3,67 kg** of CO₂ per kilo of aluminium which it means a 79,6% less than the world average for primary extraction.

At **exlabesa** main factories, we have also implemented environmental management systems such as international standard **ISO 14001** that guarantee the strict compliance of all sustainability regulations during the manufacturing process of our aluminium profiles and we have got environmental certificates of **CO₂ calculated** as well as recycled aluminium profiles and billet certificates.

All this measures we have been applying make **exlabesa** an excellent choice to any type of building projects looking for sustainability and environmental protection.

Finishes and colours

Creative freedom for your projects



Our wide range of colours and finishes for aluminium, *Colours by exlabesa*, will allow you design with total creative freedom giving your projects a completely personalized finish.

Powder-coating colour options are unlimited and available in different finishes such as gloss, textured, matt or wood while in the anodised range we offer silver finish as standard.

Furthermore, both powder-coating and anodising processes have the highest quality guarantees certified by **Qualicoat** and **Qualanod** respectively.



colours
by **exlabesa**

